

**"Your move is our motivation"**

**Ongar Road, Abridge, RM4  
Five Bedroom Semi Detached House**

**Monthly Rental Of £2,995**



A STUNNING FIVE BEDROOM HOME IN AN AMAZING SEMI-RURAL SETTING WITH FARMLAND VIEWS AND AVAILABLE NOW. THIS FINE HOME INCLUDES A HUGE OPEN PLAN BESPOKE FITTED KITCHEN / LOUNGE / DINING ROOM, A SITTING ROOM AND A GROUND FLOOR SHOWER ROOM. ON THE FIRST FLOOR THERE ARE FOUR BEDROOMS AND A SPACIOUS FAMILY BATHROOM. ON THE SECOND FLOOR THE MASTER BEDROOM HAS A VICTORIAN STYLE EN-SUITE BATH AND AMAZING VIEWS. THERE IS A VERY PRACTICAL OUTBUILDING / OFFICE / WORKSHOP WITH A TOILET, THERE IS ALSO A SEPARATE STORAGE SHED. THE REAR GARDEN IS OF AN EXCELLENT SIZE WITH AMAZING FARMLAND VIEWS, TO THE FRONT OF THE PROPERTY THERE IS BLOCK PAVED DRIVE WITH PARKING FOR TWO CARS.

- A STUNNING FIVE BEDROOM HOME AND AVAILABLE NOW
- HUGE OPEN PLAN BESPOKE FITTED KITCHEN / LOUNGE / DINING ROOM
- SITTING ROOM AND A GROUND FLOOR SHOWER ROOM
- EN-SUITE TO THE MASTER BEDROOM AND A FAMILY BATHROOM
- PRACTICAL OUTBUILDING WITH AN OFFICE / WORKSHOP AND TOILET
- HUGE GARDEN WITH FARMLAND VIEWS AND A STORAGE SHED

# Floor Plan

## Outbuildings

Approx. 27.7 sq. metres (298.7 sq. feet)

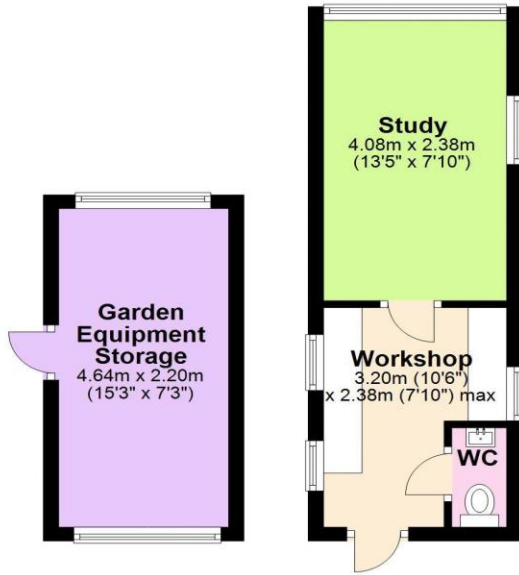

## Ground Floor

Approx. 74.2 sq. metres (798.5 sq. feet)

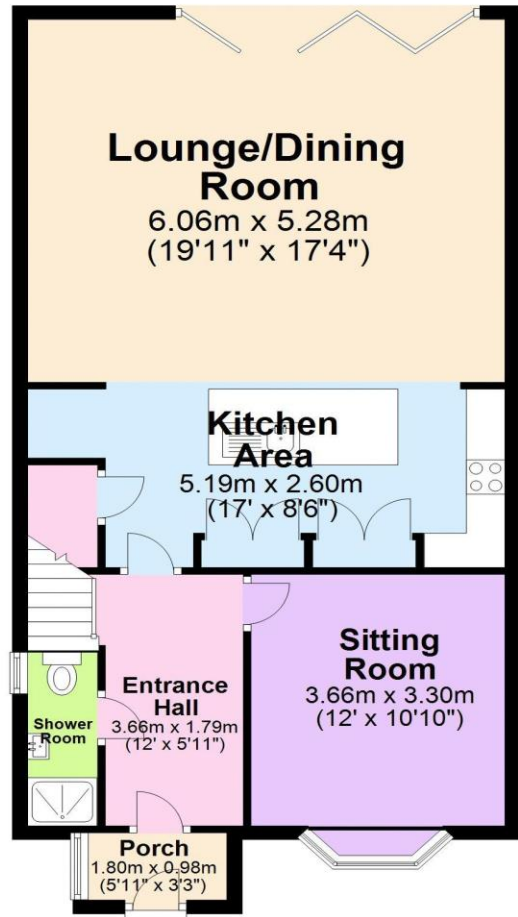

## First Floor

Approx. 63.0 sq. metres (678.0 sq. feet)



## Second Floor

Approx. 32.3 sq. metres (347.5 sq. feet)

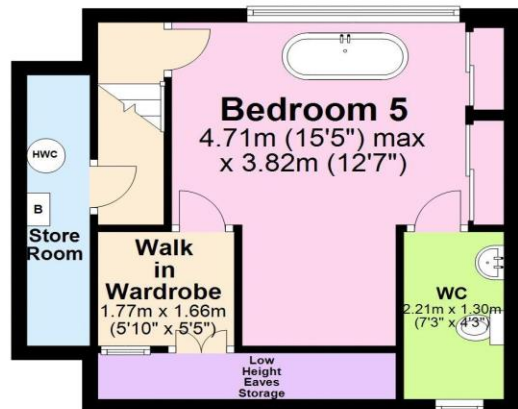

Total area: approx. 197.2 sq. metres (2122.7 sq. feet)

Illustrations are for viewing purposes only. Measurements are not to scale. Property Total and Floor Totals are Internal figures only and do not include Garden, Balconies, Patios or Terraces if any shown.  
Plan produced using PlanUp.